

Acer Value Series Projectors X1120H / X1220H

acer

Product Highlights



Sharp visuals, compelling value

Acer projector family

Acer projectors offer exceptional performance for all content, in any type of environment.

Commercial/Government

- **Professional Series**
A new standard for large venues
- **Travel Series**
Ultra-lightweight mobility with brilliance



Consumer/Crossover

- **Value Series**
Shining versatility and value
- **Home Series**
Brilliant imagery for entertainment



Value proposition

Sharp visuals, compelling value

The Acer X1120H / X1220H projectors deliver SMB or classroom presentations with impressive graphics and clarity.

Handy installation utilities make setup easy, and power-management solutions save energy. This projector is also DLP® 3D ready, so it can depict deep, lifelike visuals. To top it off, this all comes for budget-minded value.



Key selling points

Convenient settings and advanced features improve usability, presentation flexibility and eco-friendliness



DLP 3D Ready kit with high (120 Hz) refresh rates renders a flicker-free 3D experience.



Acer ColorBoost technology II+ improves the natural color temperature to achieve optical color balance and enhances color brightness according to content.



Acer ColorSafe II technology virtually eliminates color decay, and takes advantage of DLP technology to guarantee picture integrity despite prolonged use.



Acer Top-Loading Lamp Complete lamp replacement in just a few simple steps — while the projector remains ceiling-mounted.



An **HDMI**[®] port delivers uncompressed digital signals and multi-channel audio, providing easy connectivity to high-quality HD broadcasts or entertainment.



Long lamp life reduces maintenance costs and yields greater savings.

Feature highlights

Captivating visuals

(X1120H) (X1220H)

Resolution **SVGA** Resolution **XGA** Brightness **2700_{ANSI}** Contrast Ratio **3000:1** Film Support **TRUE 24P**

Installation versatility

Smart Detection Keystone Correction **40°** Digital Connectivity **HDMI** Zoom & Pan Zoom Ratio **1.1X** Dust Protection

Multi-PC Connection Top Loading Lamp Loop Through Installation Menu Signal Control **RS-232**

Empowering usability

Quick Start **Start** Instant Resume Empowering Technology **eView** Empowering Technology **eTimer** Empowering Technology **ePower** Empowering Technology **eOpening** Wall Color Compensation

SmartFormat Instant Pack Security **PIN** Built-in Speaker Closed Captioning OS Compatibility **Windows® 7 Compliance** High Altitude Mode

Earth-caring functionality

Lamp Life **6000_{hrs}** Power Saving **ECO Mode** Auto Shutdown **OFF** Low Noise Level **27 dBA** Power Consumption **1W** Standby Mode

Captivating visuals

The Acer X1120H / X1220H projector and a PC or an A/V device supporting 120 Hz output deliver a flicker-free 3D experience

DLP® 3D kit features DLP® Link™ 3D glasses for seamless 3D data transmission!



PC supporting 120 Hz output plus 3D SW player installed



Enjoy 3D classes and movies!

or

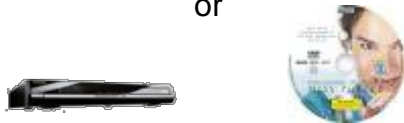

NTSC DVD player + HQFS DVD

DLP® Link™ 3D glasses

Acer X1120H / X1220H projector

Captivating visuals

Acer ColorBoost II⁺ technology

Acer ColorBoost II⁺ technology presents nature's true colors, with:

- Optimized 6-segment color wheel-design
- Powerful image processing
- Advanced lamp illumination technology



A lamp power pulse on a specific color improves brightness as the color wheel is spinning

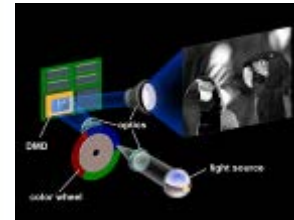

DLP® light engine

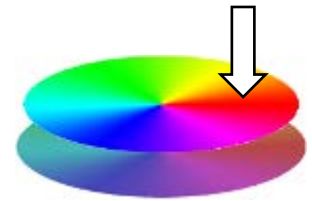

Spinning color wheel

Lamp power pulse
on yellow and red

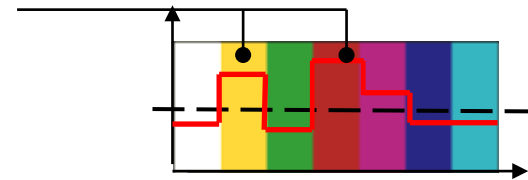

Lamp waveform

Captivating visuals

Acer ColorSafe II technology

Acer projectors featuring ColorSafe II technology use dynamic RGB gain control to secure color fidelity despite prolonged use

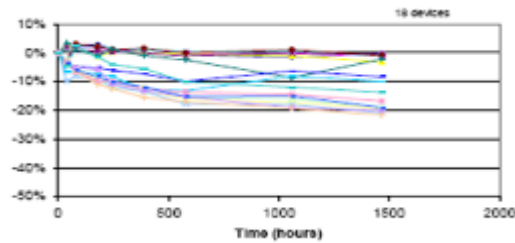

Greenish picture (Normal DLP® projectors)

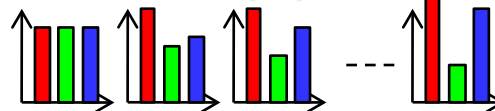
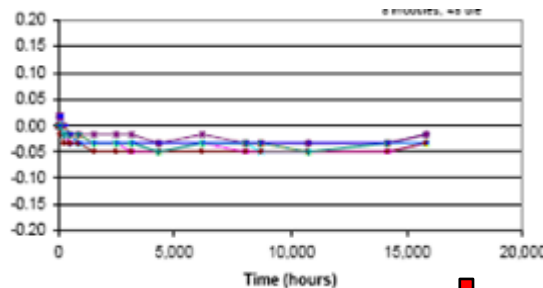

Acer dynamic RGB gain control



Corrected images with color fidelity

Captivating visuals

Acer SpectraBoost technology

Wider color gamut achieved via patented color wheel coating technology boosts 30% extra color saturation



Original

Standard projector

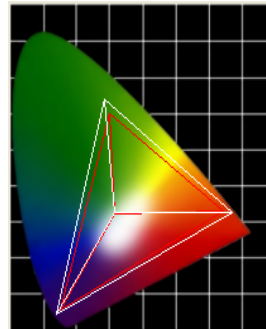
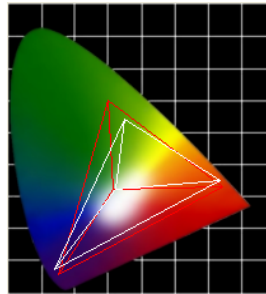

Acer projector
with SpectraBoost



Captivating visuals

High resolution, brightness, contrast ratio

- SVGA resolution presents sharp details, even for fine print.
- Higher brightness and contrast ratio project crystal-clear, vibrant images from a long distance on a large screen.

(X1120H)



(X1220H)



Installation versatility

Acer Top-Loading Lamp design

- Complete lamp replacement in just a few simple steps — while the projector remains ceiling-mounted.



Step 1: Use a screwdriver to remove the screws on the two sides of the cover.

Step 2: Remove the two screws that secure the lamp module.

Step 3: Pull up the lamp bar.

Step 4: Pull out the lamp module.

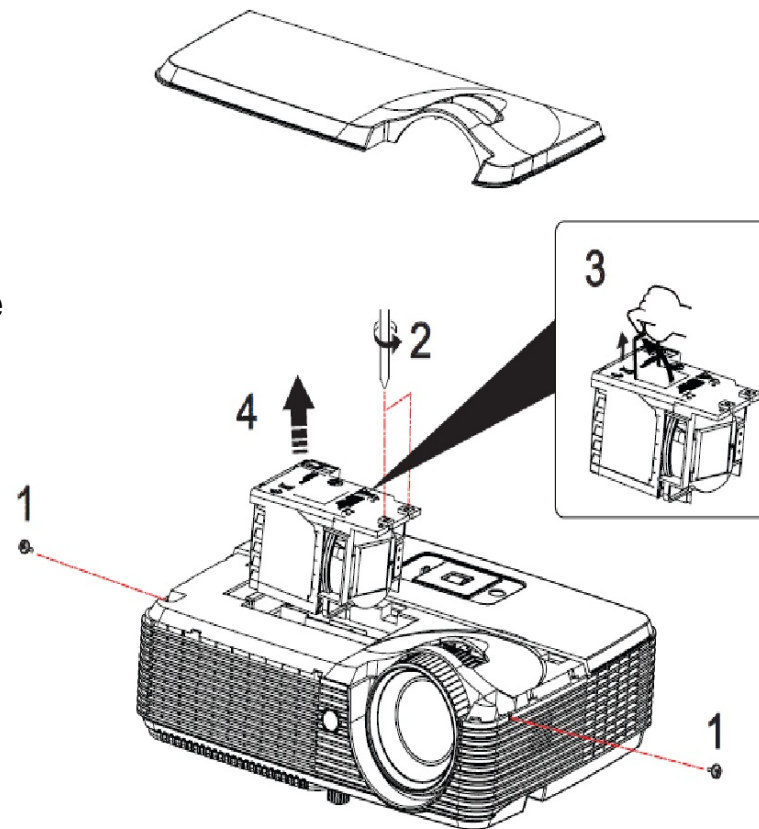

Installation versatility

Acer Smart Detection technology

- With intelligent signal priority control, signal detection time is significantly reduced.



Multi-PC connectivity

- The projector is equipped with at least two connectors for multiple-PC source input, including D-Sub and HDMI®, offering more flexible connectivity and instant switching.

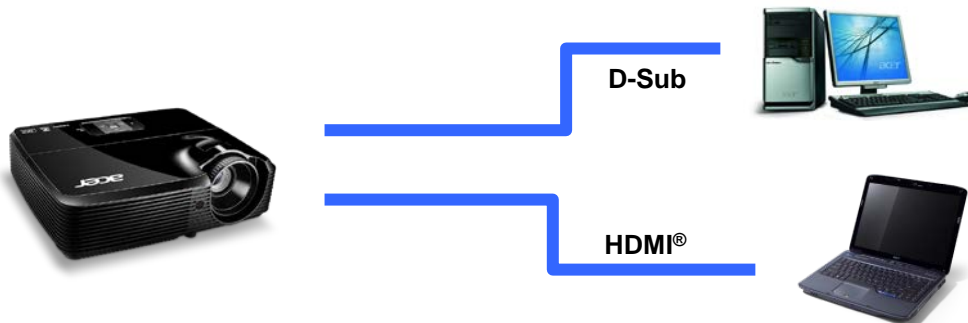

Empowering Usability

Acer SmartFormat technology

- Complete multi-format support for instant projection
- Complete widescreen format support
- Instant sync with wide-format displays without resolution adjustments from the notebook

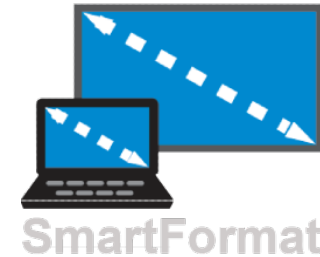

Instant resume/ Instant pack

- Instant resume: Allows next user to power up the projector right after it has been turned off.
- Instant pack: Allows end user packs the projector to go right after it has been turned off.



Earth-caring functionality

Acer EcoProjection technology

- Reduces standby power consumption by up to 50%, from 5 W to 1 W.
- With the Auto-ECO feature, the projector automatically enters ECO mode if there is no signal input for 5 minutes, resulting in up to 20% further reduction of power consumption.



EcoProjection



Longer lamp life — up to 6000 hours

- Saves lamp replacement costs and ensures long-term, dependable projector use.



Clean yet sophisticated design

The control pad is embedded on the sleek black surface, portraying design elegance and reflecting Acer's premium craftsmanship.

The sleek, glossy black surface refines the design and reflects Acer's premium craftsmanship.



Sculpted lines on the ventilation grill grace the design with sophistication.

Product views

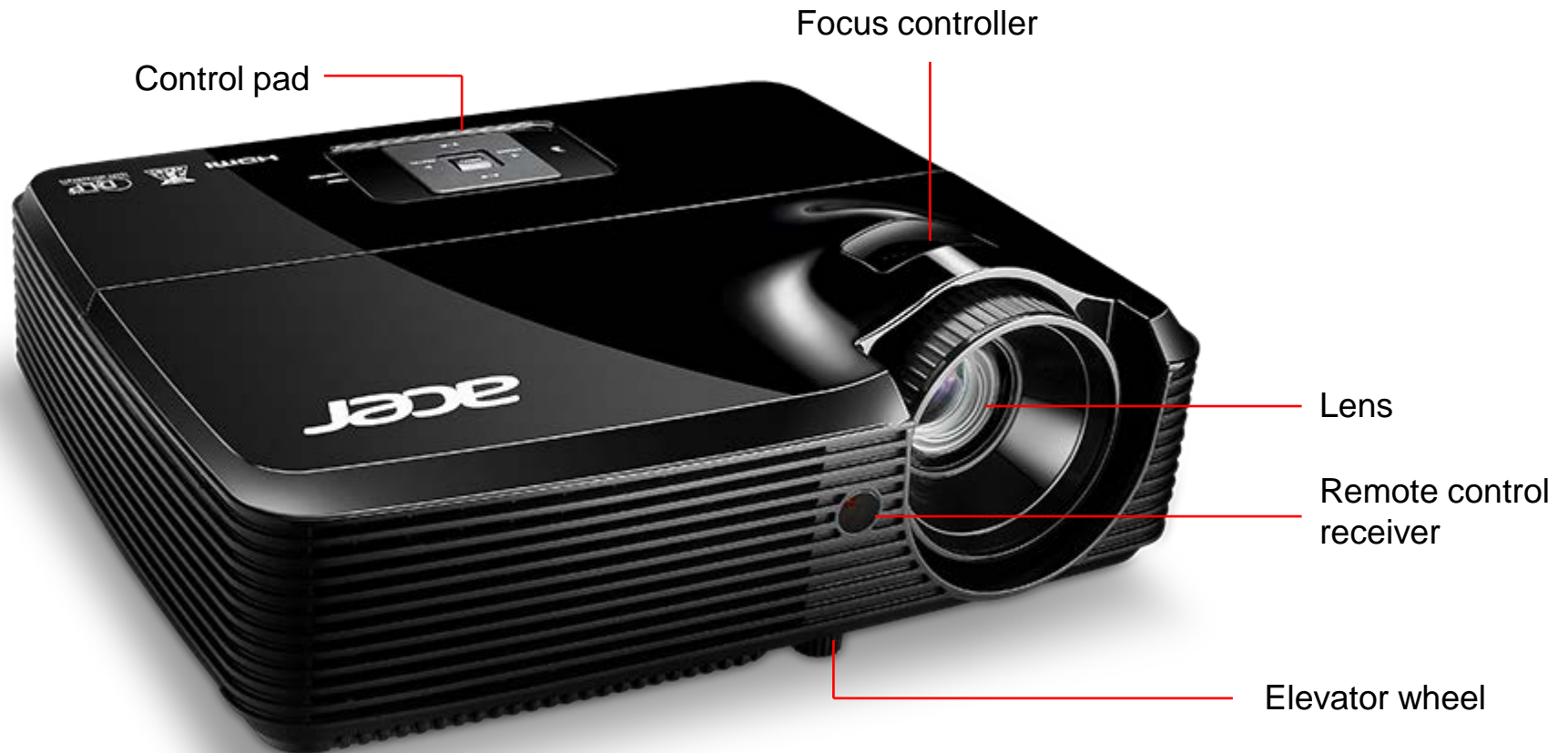

Product views

15-pin D-Sub for PC analog signal/
HDTV/component video input

9-pin RS-232 port

Composite video RCA jack

19-pin HDMI® port

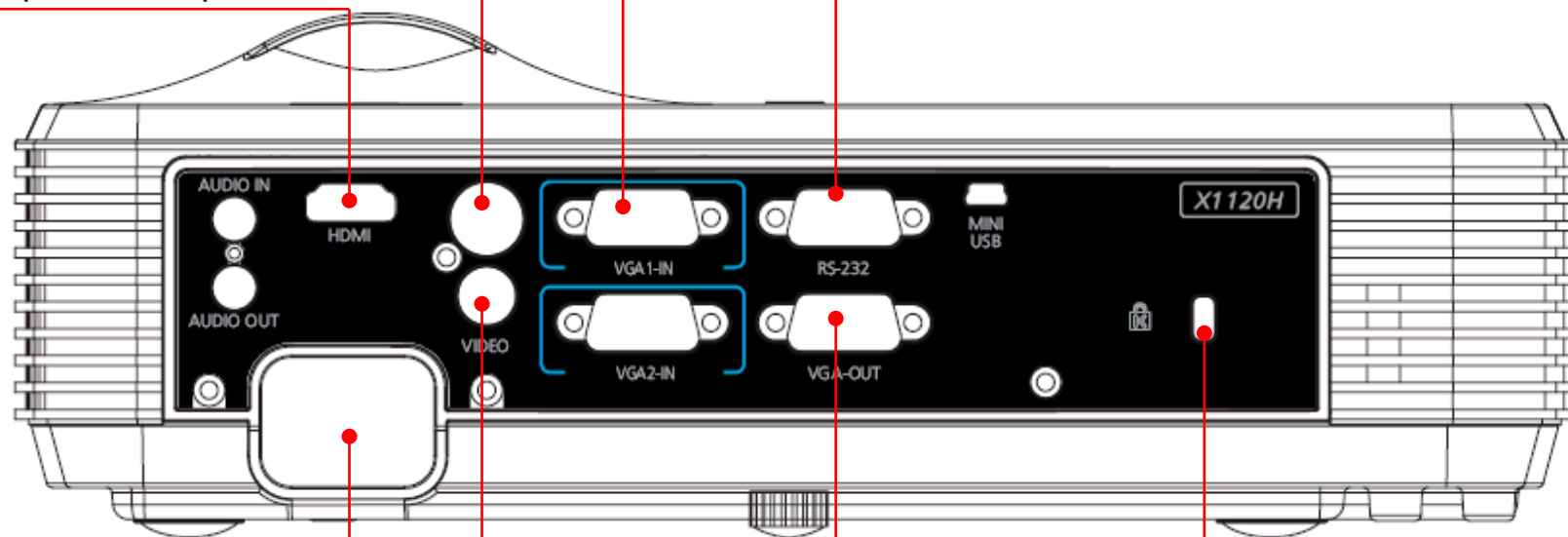

S-Video

AC-in jack

Kensington lock slot

15-pin D-Sub for monitor loop-through

Specifications



Model name	X1120H	X1220H
Display panel	0.55" DarkChip™ 3 DMD	
Resolution	Native SVGA (800 x 600) Maximum UXGA (1600 x 1200), 1080p (1920 x 1080)	Native XGA (1024 x 768) Maximum UXGA (1600 x 1200), 1080p (1920 x 1080)
Aspect ratio	4:3 (Native), 16:9	
Contrast ratio	3000:1	
Brightness	2700 ANSI lumens (Standard), 2160 ANSI lumens (ECO)	
Lamp life	5000 hours (Standard), 6000 hours (ECO)	
Projection lens	F = 2.51 ~ 2.69, f = 21.95 mm ~ 24.18 mm 1:1.1 manual zoom and manual focus	
Keystone correction	+/-40 degrees (vertical), manual	
Noise level	29 dBA (Standard), 27 dBA (ECO)	
Input interface	Analog RGB/Component Video (D-Sub) x 2 Composite Video (RCA) x 1 S-Video (Mini DIN) x 1 HDMI® (Video, Audio, HDCP) x 1 PC Audio (Stereo mini jack) x 1	
Output interface	Analog RGB (D-Sub) x 1 PC Audio (stereo mini jack) x 1	
Control Interface	USB (Mini-B) x 1 RS232 (D type) x 1	
Dimensions	284 x 234 x 92 mm (11.18 x 9.21 x 3.62 inches)	
Weight	2.3 kg (5.1 lbs.)	

Acer X1120H / X1220H

Sharp visuals, compelling value



Thank you!